

SUITE#: 507

REGENT PARK

5 NORTH REGENT ST.
LIVINGSTON, NEW JERSEY
2,488 RENTABLE SQ. FT.

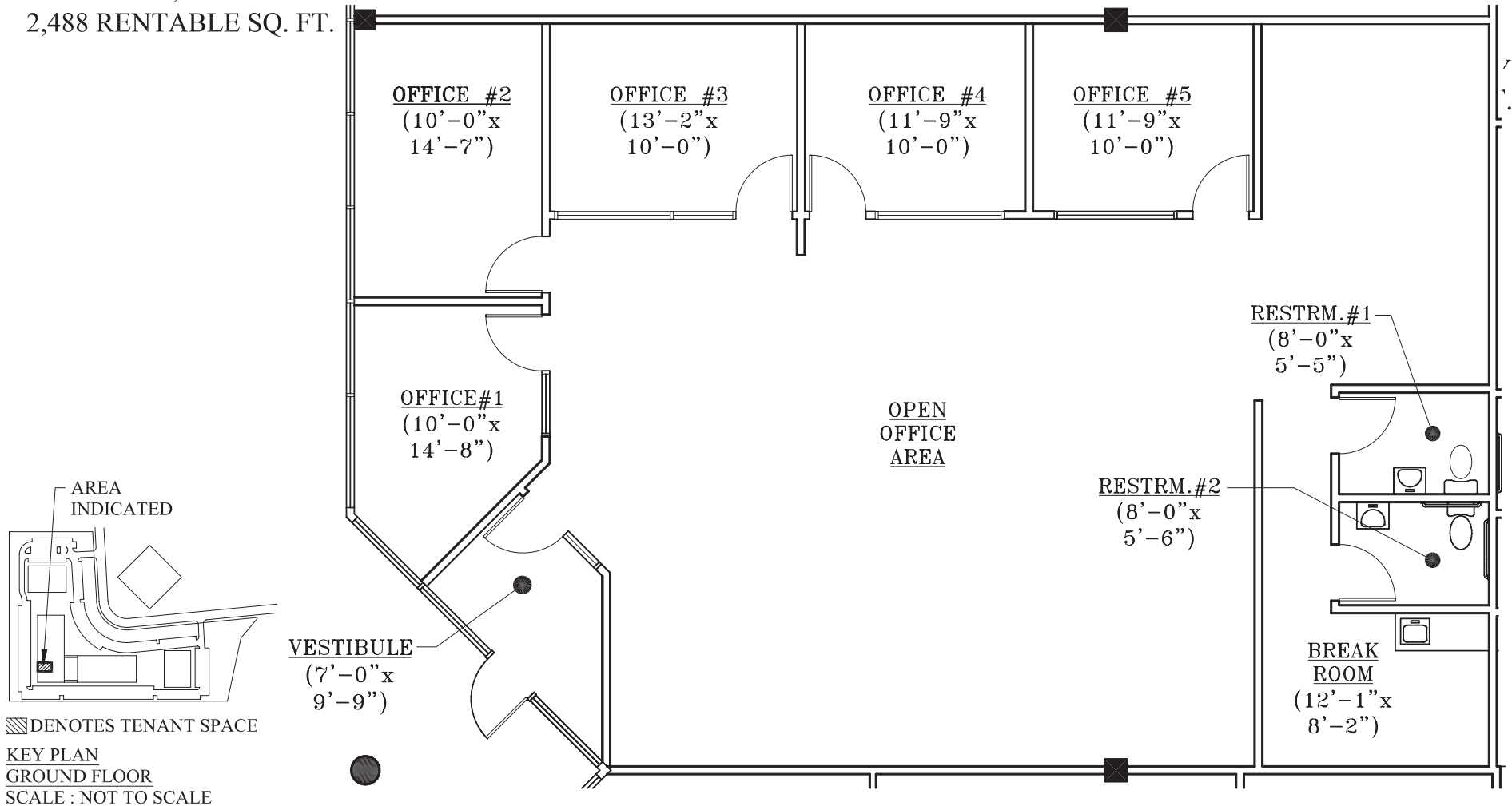

651 West Mount Pleasant Avenue
Livingston, NJ 07039-1667
T: (973) 992-7727
F: (973) 992-3084
www.eastmancompanies.com

For more information, please contact
Eric J. Maurer, Director of Leasing
T: (973) 488-6110
F: (973) 992-3084
E: ericm@eastmancompanies.com